

## STANDARD CONSTRUCTION

**FRAME:** .081" thick (nominal) extruded aluminum 6063-T52/T6 alloy.  
**BLADE:** .081" thick (nominal) extruded aluminum 6063-T52/T6 alloy.  
 Blades spaced approximately 3" on center with architectural style hidden mullions.

**SUPPORTS:** Shall incorporate rear angle 2" x 2" x 1/4" extruded aluminum to withstand windload of 20 PSF, approximately 90 mph wind. Supports vary as required, per windload. Spaced approximately 60" on centers.

**FINISH:** Mill

## OPTIONS

Variations - Mitered Corner, Post Corner, Hinged Access, and Cap Covers.

Finishes - Kynar, Baked Enamel, Clear and Color Anodize (Consult the factory for details.)

## NOTES

1. Maximum panel size should not exceed 60 sq. ft. or 120"W x 72"H. Louver sections larger than the factory maximum size will require field assembly of smaller sections.
2. Approximate shipping weight is 4.5 lbs./sq.ft.

## SCREEN SIZES

Min Panel	Max Single Panel
12"W x 12"H	120"W x 72"H (60 sq. ft.)

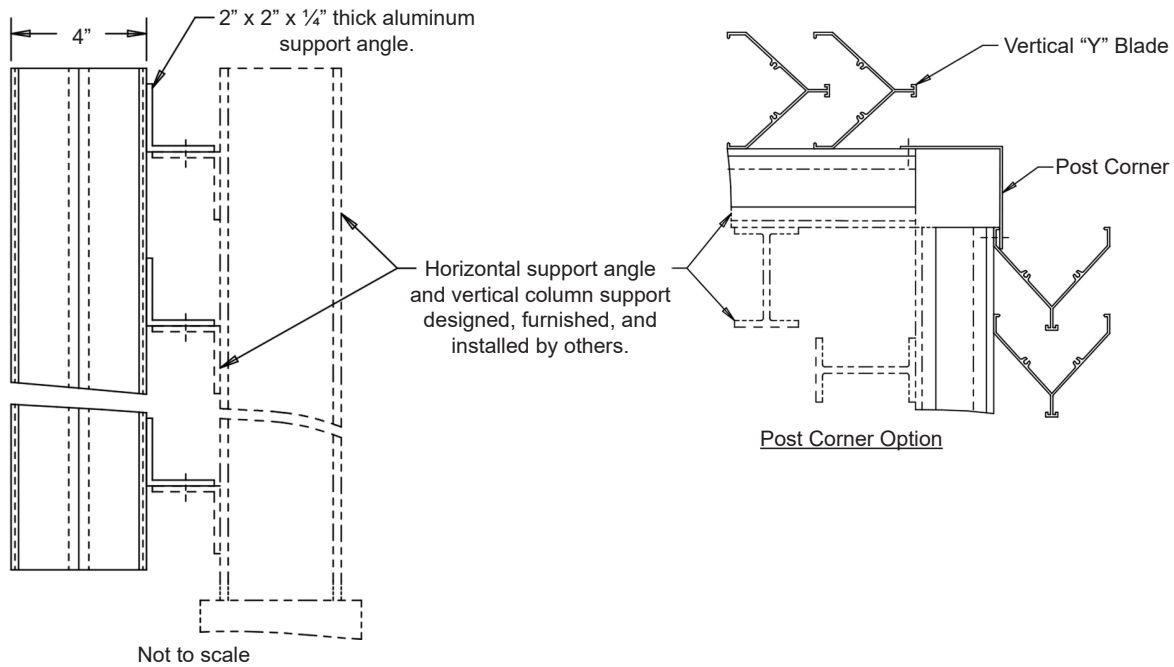
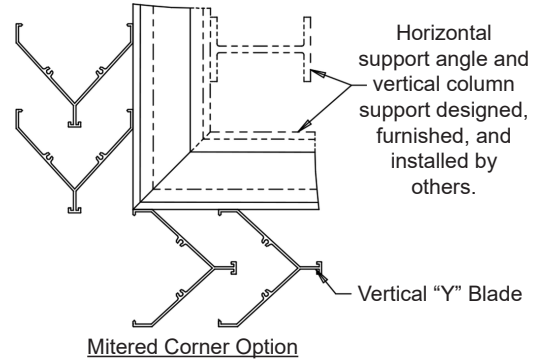

Item #	Qty	Height	Width	Mullion	Mitered	Post	Union Made	
		Screen Size			Corner Type			
Arch. / Eng. :		EDR:		ECN:	Job:			
Contractor:								
Project:		Date:		DWN:		DWG:		

In the interest of product development, Louvers & Dampers reserves the right to make changes without notice.